

STANDARD PROBE THERMOCOUPLES

STYLE

1 - PROBE WITH 3" LEADS

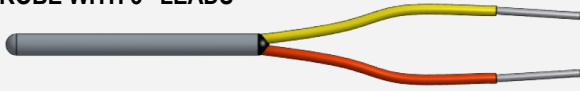

5 - SMOOTH TRANSITION

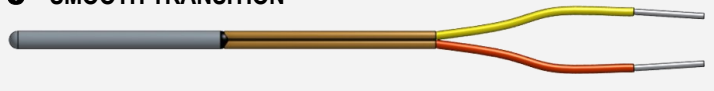

3 - SPRING RELIEF TRANSITION



6 - SPRING RELIEF TRANSITION W/ SS OVERBRAID



4 - TRANSITION WITHOUT SPRING RELIEF

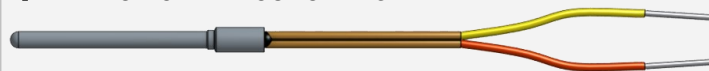

I.S.A. CALIBRATION

E - CHROMEL / CONSTANTAN

K - CHROMEL / ALUMEL

J - IRON / CONSTANTAN

T - COPPER / CONSTANTAN

MATERIAL

30 - 304 STAINLESS STEEL

32 - 316 STAINLESS STEEL

31 - 310 STAINLESS STEEL

39 - INCONEL

NUMBER OF ELEMENTS

S - SINGLE

D - DUAL

SHEATH DIAMETER

3 - 0.062"

5 - 0.188"

7 - 0.313"

4 - 0.125"

6 - 0.250"

8 - 0.375"

JUNCTION TYPE

G - GROUNDED

RR - UNGROUNDED
(DUAL ISOLATED PAIR)

R - UNGROUNDED

MOUNTING (OPTIONAL)

2911 - TAPERED SPRING (STYLES 1 / 5 ONLY)

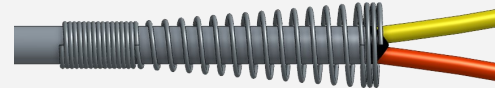

32 - SS COMPRESSION FITTING (SEE SIZE CHART)



TUBE SIZE	THREAD NPT				
	1/8	1/4	3/8	1/2	3/4
1/16	D				
1/8	E	F			
3/16	G	H		I	
1/4	J	K	M	P	
5/16		Q			
3/8		R	S	W	

T - TEFLON FERRULE

TERMINATION (OPTIONAL)

1825 - MALE ROUND PIN CONNECTOR (STYLES 3-6 ONLY)

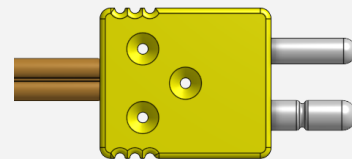

NOTE: MOST COMMON OPTIONS SHOWN ON THIS PAGE. FOR MORE PRODUCT OPTIONS, PLEASE CONTACT A THERMO-PROBES SALES REPRESENTATIVE.

PROBE STYLE	I.S.A. CALIB.	MATERIAL	# OF ELEMENTS	SHEATH DIAMETER	PROBE LENGTH (IN)	JUNCTION TYPE	LEAD WIRE LENGTH	MOUNTING OPTIONS	TERMINATION OPTION